

Notes:

- Made for Diesel Exhaust Application (1300F max outside pipe temp)
- Hot Side: Heat Treated Fiberglass fabric (1300F max)
- Double Layer .011" 321 SS Mesh (One layer sewn to fabric with 2" quilt pattern)
- Core Insulation: 1/2" 9# E-Glass Insulation
- Cold Side: Grey Silicone Coated Fiberglass (600F max)
- Layers mechanically bonded together with fiberglass thread, outer edge of wrap will exhibit a clean sewn or hemmed edge
- Connectors/Closures: 3 Stainless Steel Spring/Clip to Provide Easy "In and Out" Access to Pipe.
- Fasten Spring Clips using Stainless Steel Rivets
- Must fit Bellows in Neutral and Fully Compressed Position shown below
- Must fit Bellows in Installed Length shown below and fully cover the 8" span of flexible material but not interfere with the flange
- Position Spring Clips such that the insulation fits tightly to the bellows and will not allow any movement while in operation
- Horizontal dimensions below are for reference only they must be determined based on the sample provided (refer to DWG# 12-BDP-0010-01)**

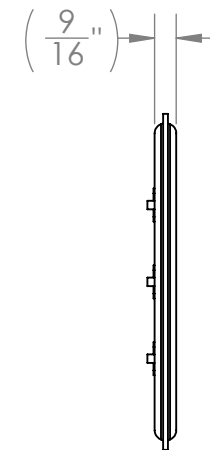

REVISIONS				
ZONE	REV.	DESCRIPTION	DATE	APPROVED
	6	Changed Hook positions and Blanket Width	31/05/2013	MJR

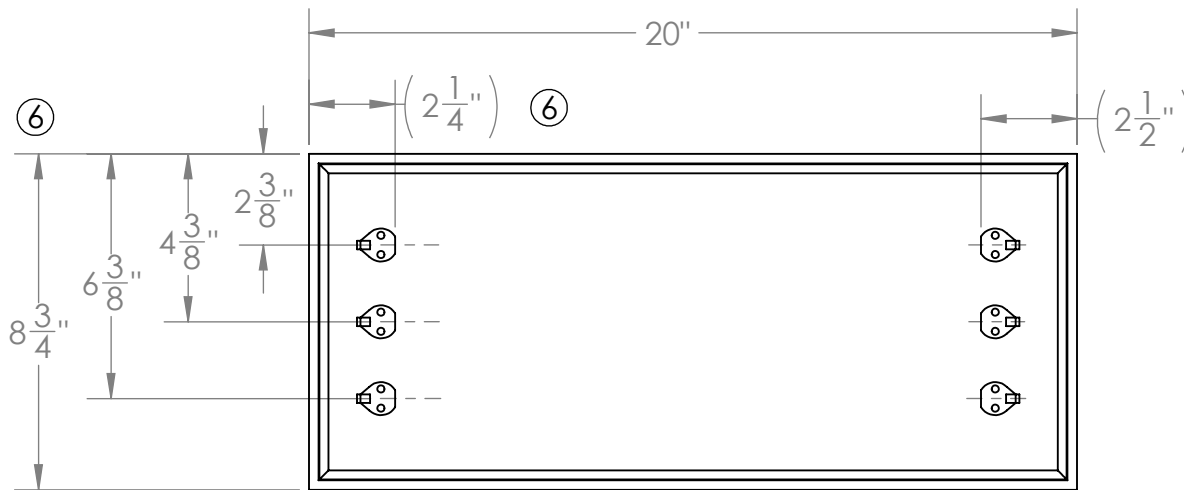
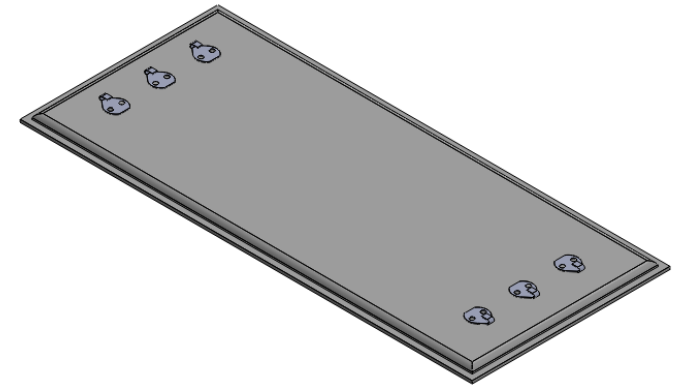

UNLESS OTHERWISE SPECIFIED:

DIMENSIONS ARE IN INCHES
 TOLERANCES:
 ANGULAR: ±0.5 DEGREES
 FRACTIONAL ±0.03
 ONE DECIMAL PLACE ±0.02
 TWO PLACE DECIMAL ±0.01
 THREE PLACE DECIMAL ±0.005

DO NOT SCALE DRAWING

MATERIAL See Notes

FINISH

COLOR

	NAME	DATE
DESIGN		
DRAWN	MJR	31MAY13
CHECKED	MJD	

NOTES:

TITLE:	Bellows Insulation [1060-CL-R6]		
SIZE	DWG. NO.	REV	
A	12-BDP-0010-00REV06	6	
SCALE: 1:8	WEIGHT:	SHEET 1 OF 1	

PROPRIETARY AND CONFIDENTIAL
 THE INFORMATION CONTAINED IN THIS DWG IS THE SOLE PROPERTY OF BDEP.
 ANY REPRODUCTION IN PART OR AS A WHOLE WITHOUT THE WRITTEN
 PERMISSION OF BDEP IS PROHIBITED.