

# 4-274 Hinge Pr01 270°

Nested door



**Product Notes:**

- Fasten to panel with screws
- RH and LH application
- Tool-less installation - see Product System 4-274SL

**Material:**

- **Leaves:** Zinc Die, Chrome Plated or Black Coated
- **Pin:** Stainless Steel

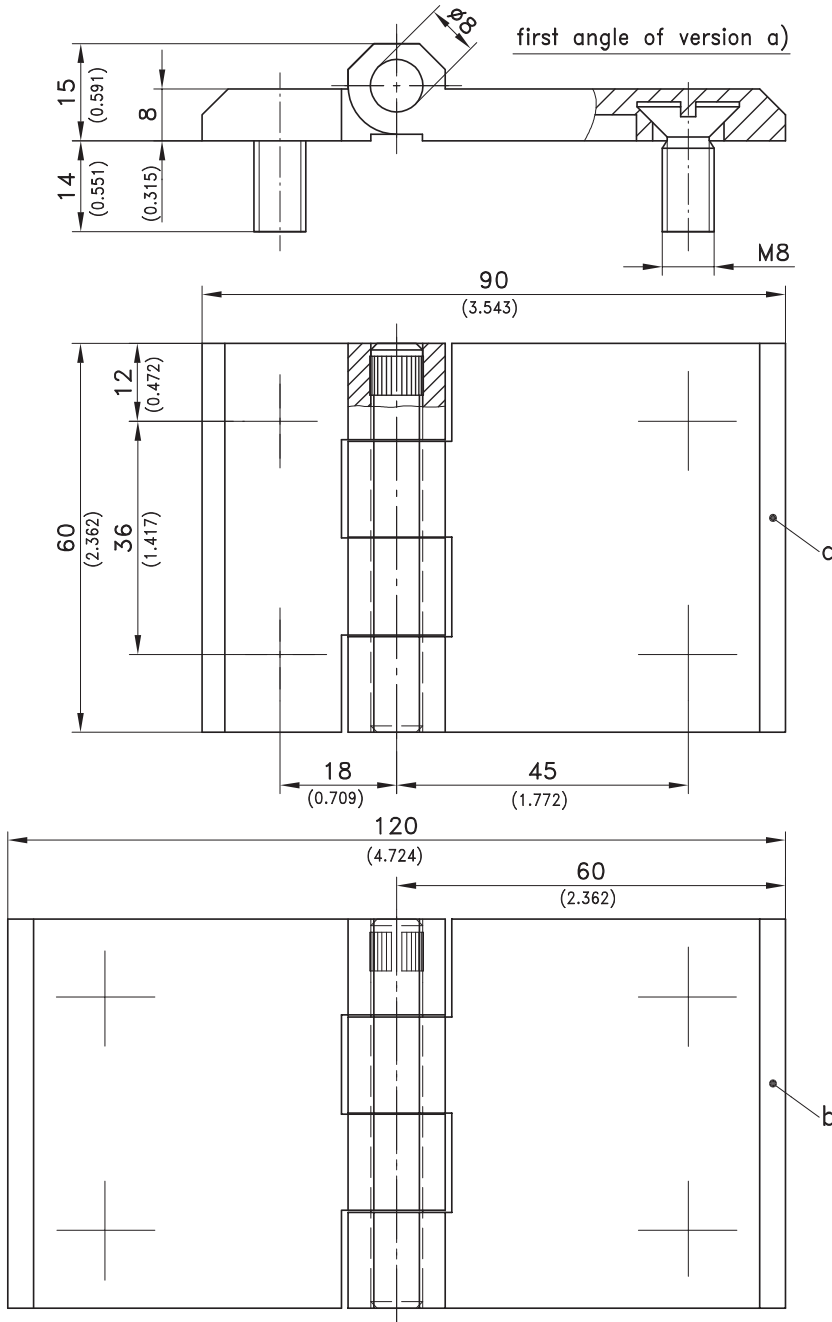

Version	Zinc Die Chrome Plated	Zinc Die Black	See Page
a) Different hinge half lengths	218-9209	218-9210	
The short hinge half length is also available with countersunk holes.			04.62, 04.75
b) Identical hinge half lengths	218-9211	218-9212	