

1-035SL Captive Fastener 9.5 SNAP-LINE

Tool-less installation, Hand or tool removeable from front, Captive in front panel



Product Notes:

- Leaf spring permanently holds fastener in the front panel
- D-SNAP technology holds fastener in back panel and is removeable
- Captive fastener eliminates the concern of losing, dropping or misplacing hardware
- For applications with several fasteners holding a panel, each can be released individually without any of the fasteners dropping out of the panel
- Leaf spring under head pushes fastener from front panel when fastener is disengaged
- Vibration resistant
- Replacement for traditional captive screw and nut applications

Material:

- **Housing:** Zinc Die, Chrome Plated or Black
- **Insert:** Steel, Zinc Plated
- **Leaf spring:** Stainless Steel
- **Wings:** Sintered Steel
- **NOTE:** The insert supplied with the black housing is steel, Zinc Plated.

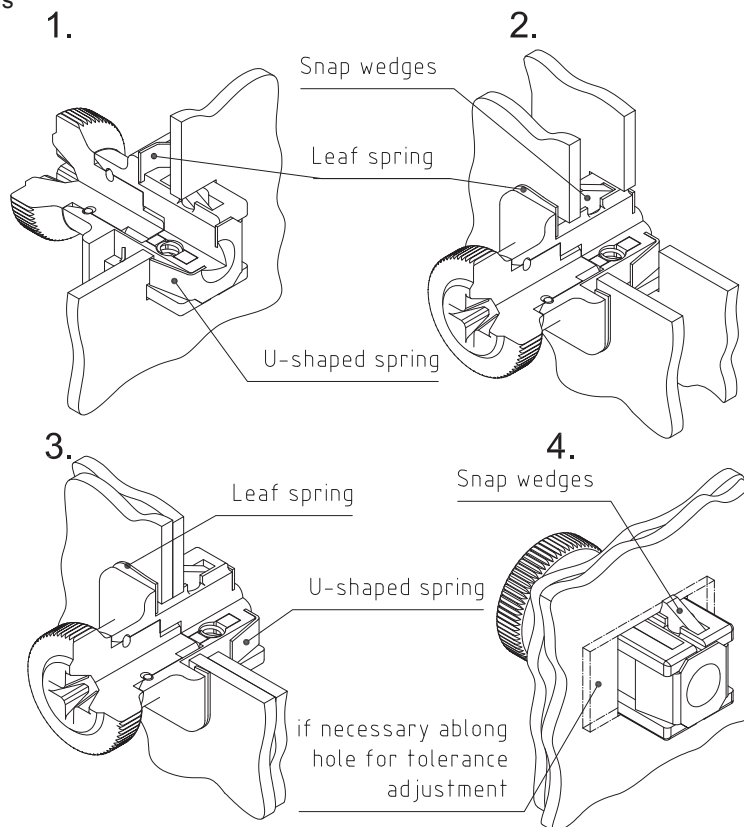

Install:

Image 1: The Captive Fastener is pushed into the front panel (e.g. 19" drawer, cover panel). The riveted U-shaped spring widens to prevent the Fastener from falling out of the panel. This keeps it secure and makes it captive. The cutout can be made larger to allow for tolerance adjustment.

Image 2: The Captive Fastener, pre-assembled in the front panel, is inserted into the cutout of the rear panel (Image 3) and kept in position by the SNAP wedges. This ensures alignment of the two panels.

Images 3 and 4: Full insertion of the Captive Fastener into the second panel securely joins the two panels for a vibration-proof connection.

Disengage Panels:

1. By turning the insert (Turning Knob or Screwdriver) the snap-wedges are pulled backwards and the front panel can be disengaged from the back panel.

2. The Captive Fastener is held in position and remains held in the front panel by the U-shaped spring.

Applications which require more than one Captive Fastener:

In applications using more than one Captive Fastener, the Captive Fastener can be pre-released, one-by-one, by turning the insert (Turning Knob or Screwdriver) and pulling the Captive Fastener until the U-shaped spring touches the front panel. When all the Captive Fasteners have been pre-released, the front panel can be removed from the back panel. The Captive Fasteners stay assembled and held in the front panel by the U-shaped spring.

1-035SL Captive Fastener 9.5 SNAP-LINE

Tool-less installation, Hand or tool removeable from front, Captive in front panel

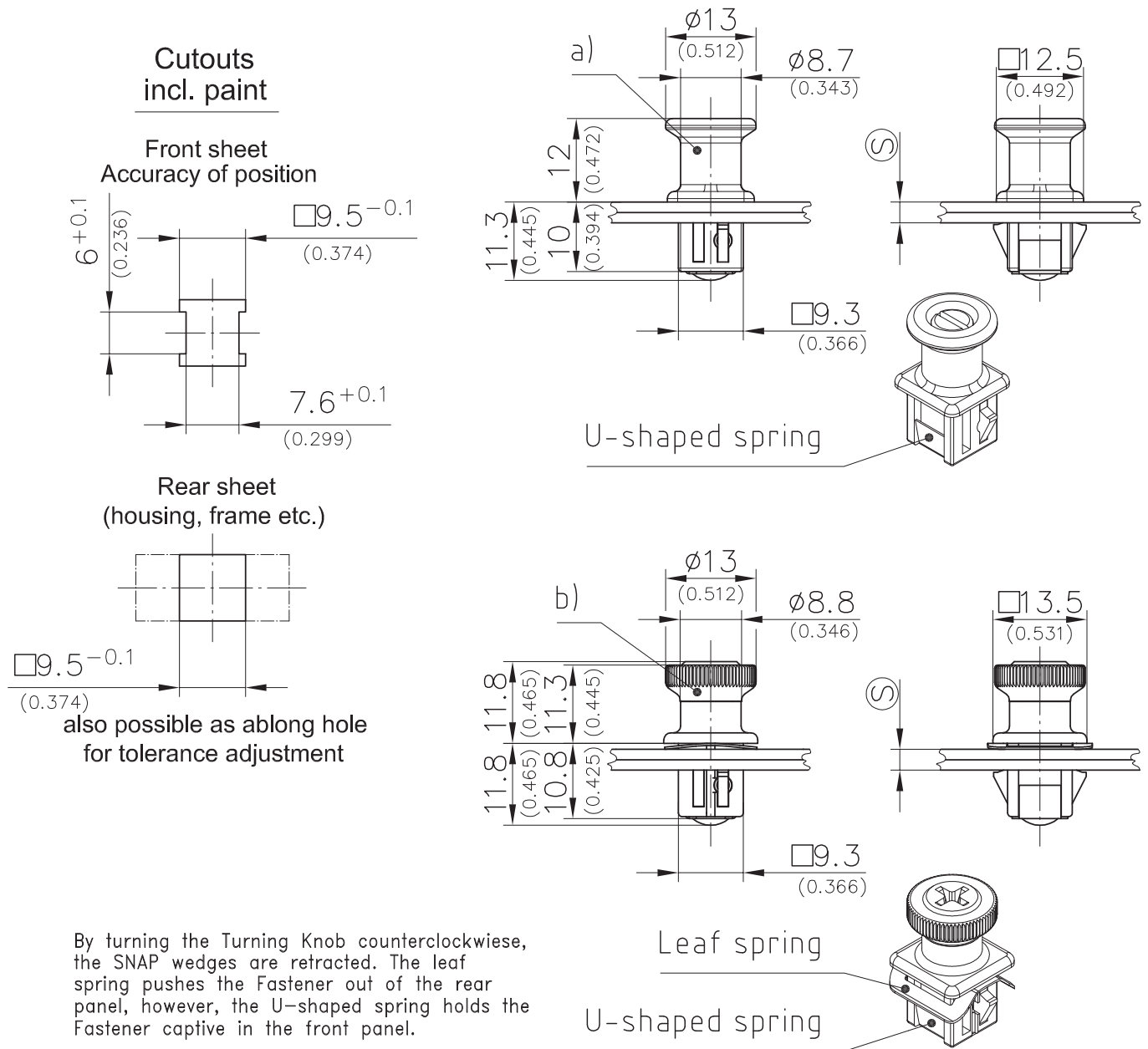

a) Fastener with handle and slotted insert

Clamping Range Ⓢ	Matt Chrome Plated	Black
1.5 - 2.2	294-9202.00-00020	294-9203.00-00020
2.3 - 2.8	294-9202.00-00025	294-9203.00-00025
2.9 - 3.4	294-9202.00-00030	294-9203.00-00030
3.5 - 4.0	294-9202.00-00038	294-9203.00-00038
4.1 - 4.6	294-9202.00-00045	294-9203.00-00045
4.7 - 5.2	294-9202.00-00050	294-9203.00-00050

b) Fastener with turning knob and recessed head plus leaf spring

Clamping Range Ⓢ	Matt Chrome Plated	Black
1.5 - 2.0	294-9210.00-00017	294-9211.00-00017
2.5 - 2.8	294-9210.00-00026	294-9211.00-00026
3.3 - 3.6	294-9210.00-00034	294-9211.00-00034
4.1 - 4.4	294-9210.00-00042	294-9211.00-00042